

# S-4611

## Portable SDI to DVI converter



### Introduction:

S-4611 is a mini converter for SDI to DVI conversion,(DVI-D, 18+1 connector), which can be widely used to display up to 3Gb/s broadcast SDI video on DVI monitor, televisions, LED board or projectors. S-4611 is heavy duty housing designed, protecting the BNC connectors well, and supplied various screw threads in the bottom, for convenient installation.

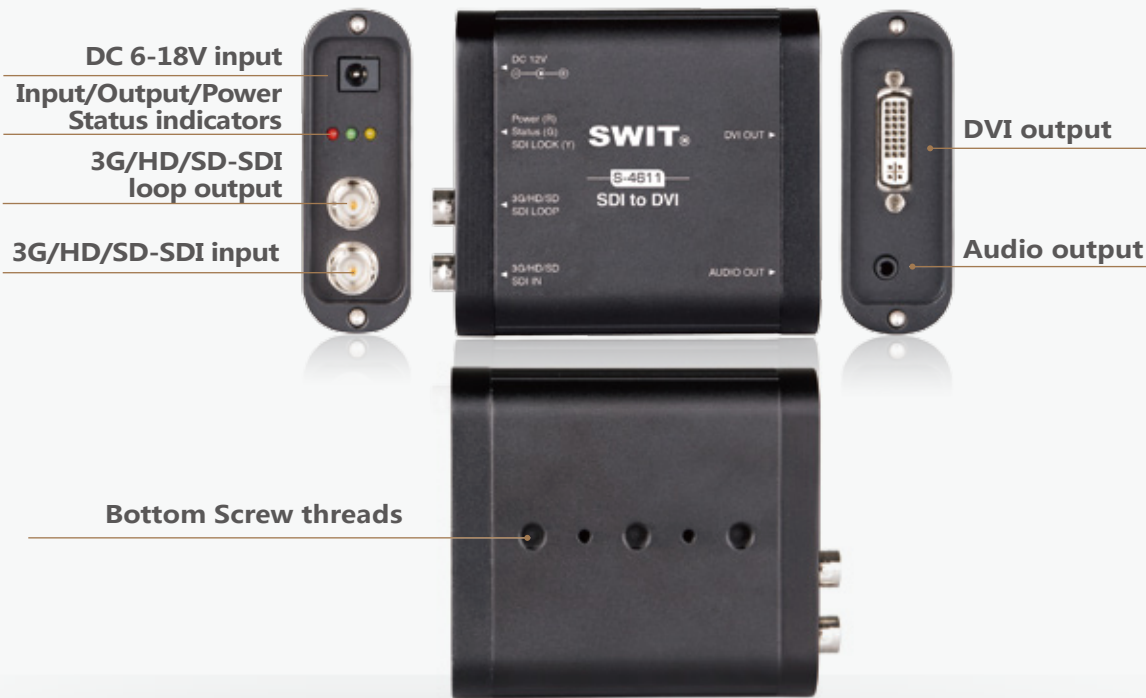

### Specifications:

Input/Output		
Input	BNC × 1	3G/HD/SD-SDI input
Output	BNC × 1	3G/HD/SD-SDI loop output
	DVI-D × 1	Converted DVI output
	3.5mm × 1	SDI audio output
Video Format		
SDI	SMPTE-425M	1080p ( 60 / 59.94 / 50 )
	SMPTE-274M	1080p ( 30 / 29.97 / 25 / 24 / 23.98 )
		1080i ( 60 / 59.94 / 50 )
	SMPTE-RP211	1080psf ( 30 / 29.97 / 25 / 24 / 23.98 )
	SMPTE-296M	720p ( 60 / 59.94 / 50 )
	ITU-R BT.656	576i ( 50 )
DVI	SMPTE-125M	480i ( 59.94 )
	1080p ( 60 / 59.94 / 50 / 30 / 29.97 / 25 / 24 / 23.98 )	1080i ( 60 / 59.94 / 50 )
		720p ( 60 / 59.94 / 50 )
		480i / 576i
Audio	48KHz Sync	
General		
Power	≤3W	
Working Voltage	DC 6-18V	
Working Environment	Temperature: 0°C-+70°C, Humidity:10%-90%	
Dimensions	98 × 84 × 29mm	
Net weight	209g	

### Features:

- ◆ Portable 3G/HD/SD-SDI to DVI Converter
- ◆ 1 SDI input, 1 DVI output, and 1 SDI loop
- ◆ SDI audio output via 3.5mm socket
- ◆ Power/input/output status indicator
- ◆ Pole-tap 6-18V DC power input
- ◆ Heavy duty aluminium housing
- ◆ Bottom screw threads for installing

### SWIT Electronics Co., Ltd.

Website:www.swit.cc  
Email:contact@swit.cc  
Tel:+86 2585805753  
Fax:+86 2585805296

Distributed by: